

Exterior House Colours



STAGETHREEDSIGN

interior design + colour consultants

CLIENT: Okato School Development
BUILDING COMPANY:
SITE ADDRESS: Carthew Street, Okato, Taranaki
PRODUCT: Exterior Concepts A-F locations
DATE: 16.06.2025

PROPOSED KAIMATUA HOUSING LOT	3. THIS PLAN IS ISSUED FOR A SPECIFIC PROJECT AND MAY NOT BE
PROPOSED ROAD TO VEST	ON SITE MEASUREMENTS MAY DIFFER FROM PLANS PLEASE CHECK MEASURE PRIOR TO STARTING Thank you. Stage Three Design
PROPOSED JOINTLY OWNED	
PROPOSED DRAINAGE	
EXISTING BUILDING TO	5. LEGAL DESCRIPTION:
INDICATIVE BUILDING AND DECK	

NOT TO SCALE

- LOT 2 DP 583334 COMPRISED IN RT 1094376 (FOR A PUBLIC SCHOOL) - 4093m².
- COMBINED AREA OF TITLES 1919m².
- THE LAND IN TITLES RT 334494 AND RT 595721 ARE SUBJECT TO A HERITAGE COVENANT CONTAINED IN 92750104.
- THERE RECORDS OF TITLE LISTED IN ITEMS ABOVE, ARE CURRENTLY OWNED BY HIS MAJESTY THE KING AND ARE RELAND UNDER THE TARANAKI IWI CLAIMS SETTLEMENT ACT 2016 - CERTIFICATE 107857001. THEY MAY BE SUBJECT TO FURTHER INSTRUMENTS AND ENCUMBRANCES AS REQUIRED ON DEPOSITION FROM THE CROWN.
- THESE NOTES ARE AN INTEGRAL PART OF THIS PLAN.

SOUTH ROAD (S.H. 45)

CARTHEW STREET
(S.H. 45)

OLD SOUTH ROAD

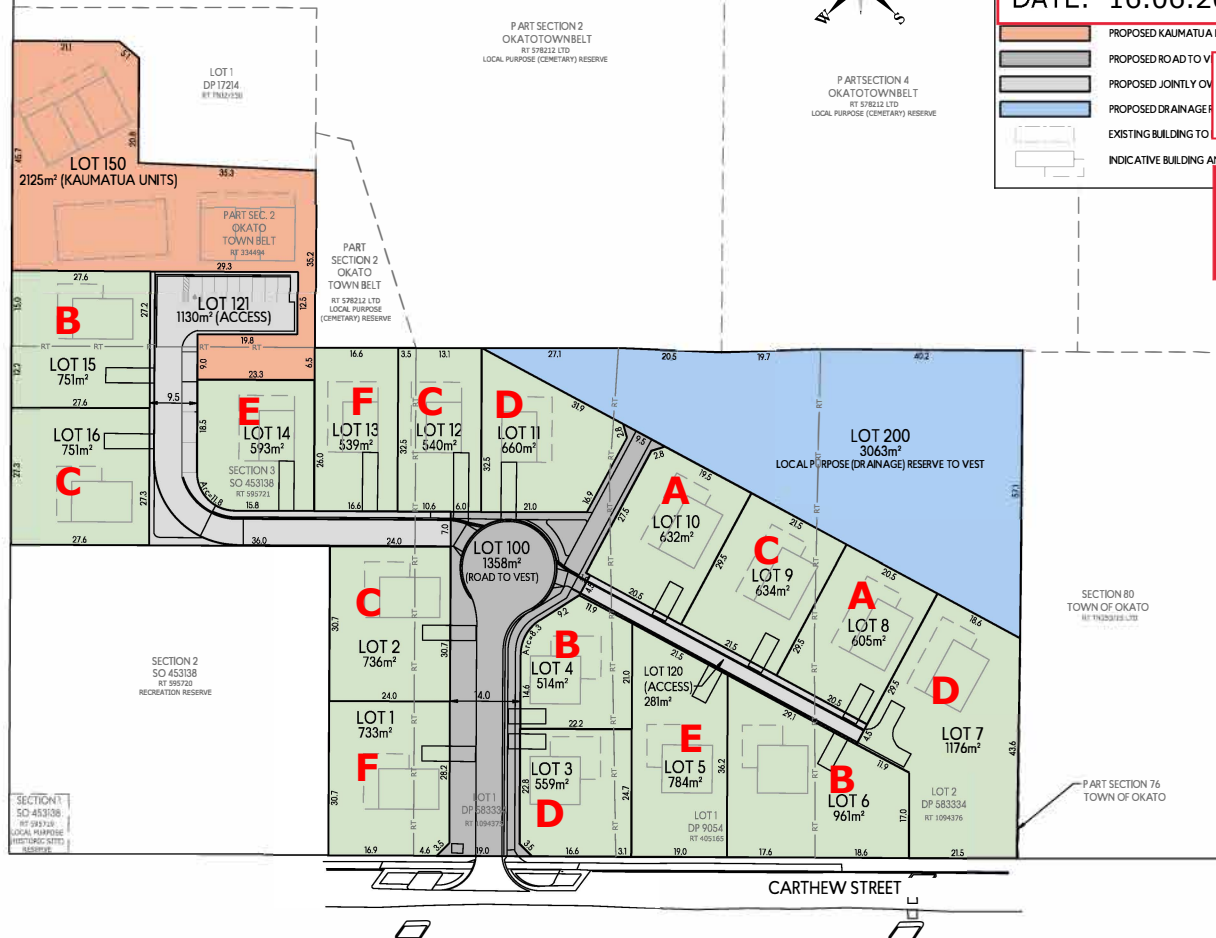

MEMORANDUM OF EASEMENTS			
PURPOSE	SHOWN	BURDENED LAND (SERVIENT TENEMENT)	BENEFITED LAND (DOMINANT TENEMENT)
RIGHT OF WAY, RIGHT TO CONVEY WATER, GAS, ELECTRICITY AND TELECOMMUNICATIONS	LOT 120	LOT 120	LOTS 5 TO 10
RIGHT TO DRAIN WATER			LOTS 5 AND 6
RIGHT OF WAY, RIGHT TO DRAIN WATER, RIGHT TO CONVEY WATER, GAS, ELECTRICITY AND TELECOMMUNICATIONS	LOT 121	LOT 121	LOTS 13 TO 16 AND LOT 150

MEMORANDUM OF EASEMENTS IN GROSS			
PURPOSE	SHOWN	BURDENED LAND (SERVIENT TENEMENT)	GRANTEE
RIGHT TO CONVEY WATER	LOTS 120	LOT 120	NEW RYLY MOUTH DISTRICT COUNCIL
RIGHT TO DRAIN WATER AND RIGHT TO CONVEY WATER	LOTS 121	LOT 121	

SCHEDULE OF PROPOSED EASEMENTS IN GROSS			
PURPOSE	SHOWN	BURDENED LAND (SERVIENT TENEMENT)	GRANTEE
RIGHT TO CONVEY TELECOMMUNICATIONS	LOT 120 AND 121	LOTS 120 AND 121	ULTRA FAST FIBRE LIMITED
RIGHT TO CONVEY GAS AND ELECTRICITY			POWER COUNCIL LIMITED

AMALGAMATION CONDITIONS:

- LOT 120 (LEGAL ACCESS) TO BE HELD AS TO SIX UNDIVIDED ONE-SIXTH SHARES BY THE OWNERS OF LOTS 5 TO 10 AS TENANTS IN COMMON IN SAID SHARES AND THAT INDIVIDUAL RECORDS OF TITLE TO BE ISSUED IN ACCORDANCE THEREWITH.
- LOT 121 (LEGAL ACCESS) TO BE HELD AS TO FIVE UNDIVIDED ONE-FIFTH SHARES BY THE OWNERS OF LOTS 13 TO 16 AND LOT 150 AS TENANTS IN COMMON IN SAID SHARES AND THAT INDIVIDUAL RECORDS OF TITLE TO BE ISSUED IN ACCORDANCE THEREWITH.

OWNERS ASSOCIATIONS:

- ALL THE OWNERS OF LOTS 5 TO 10 SHALL BECOME MEMBERS OF AN OWNERS ASSOCIATION ESTABLISHED FOR THE REPAIRS, MAINTENANCE, AMENITY AND OTHER LIKE THINGS FOR LOT 120 (ACCESS).
- ALL THE OWNERS OF LOTS 13 TO 16 AND LOT 150 SHALL BECOME MEMBERS OF AN OWNERS ASSOCIATION ESTABLISHED FOR THE REPAIRS, MAINTENANCE, AMENITY AND OTHER LIKE THINGS FOR LOT 121 (ACCESS).

This design and drawing shall only be used for the purpose for which it was supplied and shall not be altered or reproduced without the permission of Envelope Engineering Limited. No liability shall be accepted for unauthorised use of this design and drawing.

REV	NOTES	BY	DATE
R1	ISSUED FOR RESOURCE CONSENT	JEG	12/02/2023
R2	ISSUED FOR RESOURCE CONSENT	JEG	08/09/2023
R3	BUILDINGS UPDATED	JEG	20/09/2023
R4	UPDATED BUILDING, ROADING AND EXISTING BOUNDARIES	JEG	27/02/2024
R5	LOT COUNT REDUCED BY TWO LOTS	JEG	17/04/2024
R6	ROAD BOUNDARY UPDATES	JEG	06/05/2025

PROJECT:
TARANAKI IWI HOLDINGS LIMITED PARTNERSHIP
OKATO SCHOOL,
OKATO, TARANAKI.

TITLE:
SCHEME PLAN OF PROPOSED SUBDIVISION

ENVELOPE
WWW.ENVELOPE-ENG.CO.NZ

DESIGNED: JEG	DRAWN: JEG
CHECKED: TOF	DATE: 16-Jun-2025
SCALE: 1:500	SCALE AS: 1:1000
STATUS: RESOURCE CONSENT	
PROJECT No: 1653-01	DRAWING No: 108
	REVISION: R6

EXTERIOR COLOUR SCHEME CONCEPT A

Lots 8 & 10

OKATO SCHOOL DEVELOPMENT, CARTHEW STREET
TARANAKI

14.04.2025/20.06.2025



DRYDEN WOOD OIL - SLATE
TRUWOOD VERTICAL CLADDING
(IMAGE INDICATIVE ONLY)

TUITUFT
GARAGE DOOR

COLORSTEEL TUITUFT
ROOF, FASCIA/BARGE BOARDS &
SPOUTING

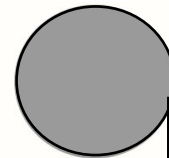

SANDSTONE GREY
DOWNPIPES

RESENE QUARTER GRAVEL
AXON CLADDING



RESENE HALF BLACK WHITE
SOFFITS



APPLIANCE WHITE
WINDOWS, JOINERY & FRONT DOOR

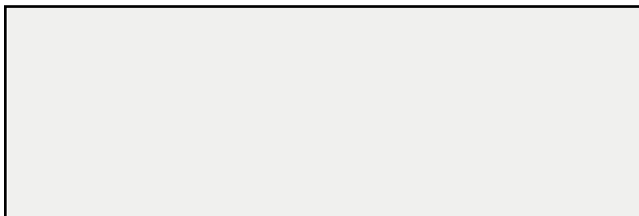

REPRESENTATION OF COLOURS ONLY - INDICATIVE ONLY
DETAILED SUPPORTING PAPERWORK ATTACHED

Wendy Elers PDINZ (Professional Member Designers Institute NZ)

Office: 1 Countryridge Close, Bella Vista Rise, Paraparaumu 5032

Mobile: 027 482 0886

Email: wendy@stagethreedesign.co.nz

Website: www.stagethreedesign.co.nz

Instagram: @stagethreedesign

interior design | colour consultation | project planning | project management

CLIENT: Okato School Development

SITE ADDRESS: Okato School, Carthew Street, Taranaki Status: **DRAFT – NOT FOR RELEASE**

DATE: 14.04.2025/20.06.2025

EXTERIOR – CONCEPT A (Lots 8 & 10) (clients advised us - no colour restrictions apply on this site)		
	Product	Colour/Finish
Roof	Colorsteel	Tui Tuft
Soffit Flashing & Beading	Aluminium & timber (where applicable)	Painted (same colour as <u>cladding</u>)
Fascia/Barge Boards	Colorsteel	Tui Tuft
Spouting	Colorsteel	Tui Tuft
Downpipes	Colorsteel	Tui Tuft
Soffits	Painted	Resene Half Black White
Cladding 1	JH Axon 400 - vertical (painted)	Resene Quarter Gravel Base: Light LRV: 24%
Cladding 2	Truwood – vertical (stained)	Oil Product: Dryden Wood Oil Colour: Slate
Base of House	Painted (<i>only if a requirement from Council</i>)	Resene Atmosphere
Balustrading	Nil	
Garage Door (<i>not insulated</i>)	Brand: Dominator (or similar) Style: Montana Finish: Smooth	Colour: Tui Tuft
Garage Door Reveal	Timber (painted)	Resene Half Black White
Garage Door Head Flashing	Powdercoated or painted same colour as reveal	Appliance White (powdercoated) OR Resene Half Black White (painted)
Aluminium Joinery (<i>with clear glass which has a slight tint</i>)	Powdercoated with Low E Glass	Appliance White
Cat Door	No	
Front Door	Aluminium Vertical T&G (powdercoated)	Mannex colour: Appliance White
Front Door Handle	Kanso Lever Handle	Colour matched to front door

***Kanso hardware to all aluminium joinery – colour matched to joinery

ALL SAMPLES GIVEN OUT AT COLOUR CONSULTATION MEETINGS ARE INDICATIVE ONLY AS SOME FINISHES MAY CHANGE WITHOUT NOTICE
ALL PRODUCTS ARE SUBJECT TO AVAILABILITY AT TIME OF ORDERING

Wendy Elers PDINZ (Professional Member Designers Institute of NZ)

Office: 1 Countryridge Close, Bella Vista Rise, Paraparaumu 5032
M: 027 482 0886 | T: 04 298 8000
Email: info@stagethreedesign.co.nz
Website: www.stagethreedesign.co.nz

interior design | colour consultation | project planning | project management



EXTERIOR COLOUR SCHEME CONCEPT B
Lots 4, 6, 15
OKATO SCHOOL DEVELOPMENT, CARTHEW STREET
TARANAKI

14.04.2025/20.06.2025

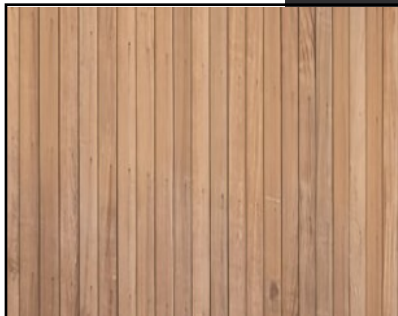

DRYDEN WOOD OIL - SLATE
TRUWOOD VERTICAL CLADDING
(IMAGE INDICATIVE ONLY)



GULL GREY
GARAGE DOOR

COLORSTEEL FLAXPOD
ROOF, FASCIA/BARGE BOARDS &
SPOUTING

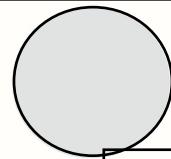

TUITUFT
DOWNPIPES

RESENE DOUBLE SEA FOG
STRIA OR LINEA CLADDING



RESENE HALF BLACK WHITE
SOFFITS



FLAXPOD
WINDOWS, JOINERY &
FRONT DOOR



REPRESENTATION OF COLOURS ONLY - INDICATIVE ONLY
DETAILED SUPPORTING PAPERWORK ATTACHED

Wendy Elers PDINZ (Professional Member Designers Institute NZ)

Office: 1 Countryridge Close, Bella Vista Rise, Paraparaumu 5032

Mobile: 027 482 0886

Email: wendy@stagethreedesign.co.nz

Website: www.stagethreedesign.co.nz

Instagram: @stagethreedesign

interior design | colour consultation | project planning | project management

CLIENT: Okato School Development

SITE ADDRESS: Okato School, Carthew Street, Taranaki Status: **DRAFT – NOT FOR RELEASE**

DATE: 14.04.2025/20.06.2025

EXTERIOR – CONCEPT B (Lots 4, 6, 15) (clients advised us - no colour restrictions apply on this site)		
	Product	Colour/Finish
Roof	Colorsteel	Flaxpod
Soffit Flashing & Beading	Aluminium & timber (where applicable)	Painted (same colour as <u>cladding</u>)
Fascia/Barge Boards	Colorsteel	Flaxpod
Spouting	Colorsteel	Flaxpod
Downpipes	Colorsteel	Tui Tuft
Soffits	Painted	Resene Half Black White
Cladding 1	JH Stria - horizontal (painted) OR JH Linea weatherboard (painted)	Resene Double Sea Fog Base: White LRV: 76%
Cladding 2 (stainless steel nails)	Truwood – vertical (stained)	Oil Product: Dryden Wood Oil Colour: Slate
Base of House	Painted (only if a requirement from Council)	Resene Atmosphere
Balustrading	Nil	
Garage Door (not insulated)	Brand: Dominator (or similar) Style: Montana Finish: Smooth	Colour: Gull Grey
Garage Door Reveal	Timber (painted)	Resene Double Sea Fog
Garage Door Head Flashing	Powdercoated or painted same colour as reveal	Appliance White (powdercoated) OR Resene Double Sea Fog (painted)
Aluminium Joinery (with clear glass which has a slight tint)	Powdercoated with Low E Glass	Flaxpod Matt
Cat Door	No	
Front Door	Aluminium Vertical T&G (powdercoated)	Mannex colour: Flaxpod
Front Door Handle	Kanso Lever Handle	Colour matched to front door

***Kanso hardware to all aluminium joinery – colour matched to joinery

ALL SAMPLES GIVEN OUT AT COLOUR CONSULTATION MEETINGS ARE INDICATIVE ONLY AS SOME FINISHES MAY CHANGE WITHOUT NOTICE
ALL PRODUCTS ARE SUBJECT TO AVAILABILITY AT TIME OF ORDERING

Wendy Elers PDINZ (Professional Member Designers Institute of NZ)

Office: 1 Countryridge Close, Bella Vista Rise, Paraparaumu 5032
M: 027 482 0886 | T: 04 298 8000
Email: info@stagethreedesign.co.nz
Website: www.stagethreedesign.co.nz

interior design | colour consultation | project planning | project management



EXTERIOR COLOUR SCHEME CONCEPT C
Lots 2, 9, 12, 16
OKATO SCHOOL DEVELOPMENT, CARTHEW STREET
TARANAKI

14.04.2025/20.06.2025

COLORSTEEL SLATE
ROOF, FASCIA/BARGE BOARDS &
SPOUTING

SANDSTONE GREY
GARAGE DOOR

RESENE DOUBLE SEA FOG
AXON CLADDING

SLATE
DOWNPIPES



RESENE GAUNTLET
LINEA CLADDING

CHARCOAL
WINDOWS, JOINERY & FRONT DOOR



REPRESENTATION OF COLOURS ONLY - INDICATIVE ONLY
DETAILED SUPPORTING PAPERWORK ATTACHED

Wendy Elers PDINZ (Professional Member Designers Institute NZ)

Office: 1 Countryridge Close, Bella Vista Rise, Paraparaumu 5032

Mobile: 027 482 0886

Email: wendy@stagethreedesign.co.nz

Website: www.stagethreedesign.co.nz

Instagram: @stagethreedesign

interior design | colour consultation | project planning | project management

CLIENT: Okato School Development

SITE ADDRESS: Okato School, Carthew Street, Taranaki Status: **DRAFT – NOT FOR RELEASE**

DATE: 14.04.2025/20.06.2025

EXTERIOR – CONCEPT C (Lots 2, 9, 12, 16) (clients advised us - no colour restrictions apply on this site)		
	Product	Colour/Finish
Roof	Colorsteel	Slate
Soffit Flashing & Beading	Aluminium & timber (where applicable)	Painted (same colour as <u>cladding</u>)
Fascia/Barge Boards	Colorsteel	Slate
Spouting	Colorsteel	Slate
Downpipes	Colorsteel	Slate
Soffits	Painted	Resene Half Black White
Cladding 1	JH Linea weatherboard – horizontal (painted)	Resene Gauntlet Base: Pastel LRV: 25%
Cladding 2	JH Axon 133 or 400 – vertical (painted)	Resene: Double Sea Fog Base: White LRV: 39%
Base of House	Painted (<i>only if a requirement from Council</i>)	Resene Atmosphere
Balustrading	Nil	
Garage Door (<i>not insulated</i>)	Brand: Dominator (or similar) Style: Milano Finish: Smooth	Colour: Sandstone Grey
Garage Door Reveal	Timber (painted)	Resene Double Sea Fog
Garage Door Head Flashing	Powdercoated or painted same colour as reveal	Appliance White (powdercoated) OR Resene Half Black White (painted)
Aluminium Joinery (<i>with clear glass which has a slight tint</i>)	Powdercoated with Low E Glass	Charcoal (Matt)
Cat Door	No	
Front Door	Aluminium Vertical T&G (powdercoated)	Mannex colour: Charcoal
Front Door Handle	Kanso Lever Handle	Colour matched to front door

***Kanso hardware to all aluminium joinery – colour matched to joinery

ALL SAMPLES GIVEN OUT AT COLOUR CONSULTATION MEETINGS ARE INDICATIVE ONLY AS SOME FINISHES MAY CHANGE WITHOUT NOTICE
ALL PRODUCTS ARE SUBJECT TO AVAILABILITY AT TIME OF ORDERING

Wendy Elers PDINZ (Professional Member Designers Institute of NZ)

Office: 1 Countryridge Close, Bella Vista Rise, Paraparaumu 5032
M: 027 482 0886 | T: 04 298 8000
Email: info@stagethreedesign.co.nz
Website: www.stagethreedesign.co.nz

interior design | colour consultation | project planning | project management



EXTERIOR COLOUR SCHEME CONCEPT D
Lots 3, 7, 11
OKATO SCHOOL DEVELOPMENT, CARTHEW STREET
TARANAKI
14.04.2025

COLORSTEEL GREY FRIARS
ROOF, FASCIA/BARGE BOARDS &
SPOUTING

SANDSTONE GREY
GARAGE DOOR

RESENE QTR FRIAR GREYSTONE
AXON CLADDING

GREY FRIARS
DOWNPIPES

now called
QUARTER FRIAR GREYSTONE

Resene Quarter Friar Grey

Resene Triple Black White

RESENE TRIPLE BLACK WHITE
STRIA CLADDING



SANDSTONE GREY
WINDOWS & JOINERY

WARM WHITE PEARL
FRONT DOOR



REPRESENTATION OF COLOURS ONLY - INDICATIVE ONLY
DETAILED SUPPORTING PAPERWORK ATTACHED

Wendy Elers PDINZ (Professional Member Designers Institute NZ)

Office: 1 Countryridge Close, Bella Vista Rise, Paraparaumu 5032

Mobile: 027 482 0886

Email: wendy@stagethreedesign.co.nz

Website: www.stagethreedesign.co.nz

Instagram: @stagethreedesign

interior design | colour consultation | project planning | project management

CLIENT: Okato School Development

SITE ADDRESS: Okato School, Carthew Street, Taranaki **Status:** **DRAFT – NOT FOR RELEASE**

DATE: 14.04.2025

EXTERIOR – CONCEPT D (Lots 3, 7, 11) (clients advised us - no colour restrictions apply on this site)		
	Product	Colour/Finish
Roof	Colorsteel	Grey Friars
Soffit Flashing & Beading	Aluminium & timber (where applicable)	Painted (same colour as <u>cladding</u>)
Fascia/Barge Boards	Colorsteel	Grey Friars
Spouting	Colorsteel	Grey Friars
Downpipes	Colorsteel	Grey Friars
Soffits	Painted	Resene Half Black White
Cladding 1	JH Axon 133 - vertical (painted)	Resene Quarter Friar Greystone Base: White LRV: 46%
Cladding 2	JH Stria – horizontal (painted)	Resene: Triple Black White Base: White LRV: 71%
Base of House	Painted <i>(only if a requirement from Council)</i>	Resene Atmosphere
Balustrading	Nil	
Garage Door <i>(not insulated)</i>	Brand: Dominator (or similar) Style: Milano Finish: Smooth	Colour: Sandstone Grey
Garage Door Reveal	Timber (painted)	Resene Triple Black White
Garage Door Head Flashing	Powdercoated or painted same colour as reveal	Appliance White (powdercoated) OR Resene Triple Black White (painted)
Aluminium Joinery <i>(with clear glass which has a slight tint)</i>	Powdercoated with Low E Glass	Sandstone Grey
Cat Door	No	
Front Door	Aluminium Vertical T&G (powdercoated)	Mannex colour: Warm White Pearl
Front Door Handle	Kanso Lever Handle	Colour matched to front door

***Kanso hardware to all aluminium joinery – colour matched to joinery

ALL SAMPLES GIVEN OUT AT COLOUR CONSULTATION MEETINGS ARE INDICATIVE ONLY AS SOME FINISHES MAY CHANGE WITHOUT NOTICE
ALL PRODUCTS ARE SUBJECT TO AVAILABILITY AT TIME OF ORDERING

Wendy Elers PDINZ (Professional Member Designers Institute of NZ)

Office: 1 Countryridge Close, Bella Vista Rise, Paraparaumu 5032
M: 027 482 0886 | T: 04 298 8000
Email: info@stagethreedesign.co.nz
Website: www.stagethreedesign.co.nz

interior design | colour consultation | project planning | project management



EXTERIOR COLOUR SCHEME CONCEPT E

Lots 5, 14
OKATO SCHOOL DEVELOPMENT, CARTHEW STREET
TARANAKI

16.06.2025/20.06.2025

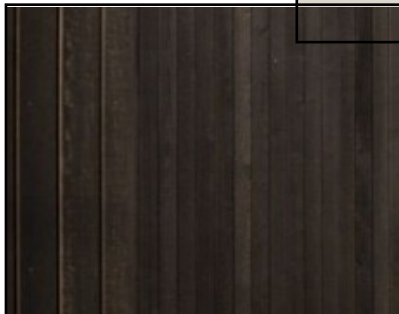

DRYDEN WOOD OIL - MIDNIGHT
TRUWOOD VERTICAL CLADDING
(IMAGE INDICATIVE ONLY)



TITANIA
WINDOWS, JOINERY &
FRONT DOOR



TITANIA
GARAGE DOOR

RESENE DOUBLE BISON HIDE
STRIA OR LINEA CLADDING



COLORSTEEL TITANIA
ROOF, FASCIA/BARGE BOARDS &
SPOUTING

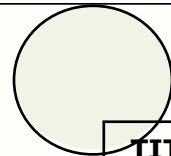

TITANIA
DOWNPIPES



RESENE HALF BLACK WHITE
SOFFITS



REPRESENTATION OF COLOURS ONLY - INDICATIVE ONLY
DETAILED SUPPORTING PAPERWORK ATTACHED

Wendy Elers PDINZ (Professional Member Designers Institute NZ)

Office: 1 Countryridge Close, Bella Vista Rise, Paraparaumu 5032

Mobile: 027 482 0886

Email: wendy@stagethreedesign.co.nz

Website: www.stagethreedesign.co.nz

Instagram: @stagethreedesign

interior design | colour consultation | project planning | project management

CLIENT: Okato School Development

SITE ADDRESS: Okato School, Carthew Street, Taranaki Status: **DRAFT – NOT FOR RELEASE**

DATE: 16.06.2025/20.06.2025

EXTERIOR – CONCEPT E (Lots 5, 14) (clients advised us - no colour restrictions apply on this site)		
	Product	Colour/Finish
Roof	Colorsteel	Titania
Soffit Flashing & Beading	Aluminium & timber (where applicable)	Painted (same colour as <u>cladding</u>)
Fascia/Barge Boards	Colorsteel	Titania
Spouting	Colorsteel	Titania
Downpipes	Colorsteel	Titania
Soffits	Painted	Resene Half Black White
Cladding 1	JH Stria - horizontal (painted) OR JH Linea weatherboard (painted)	Resene Double Bison Hide Base: Pastel LRV: 38%
Cladding 2 (stainless steel nails)	Truwood – vertical (stained)	Oil Product: Dryden Wood Oil Colour: Midnight
Base of House	Painted (only if a requirement from Council)	Resene Atmosphere
Balustrading	Nil	
Garage Door (not insulated)	Brand: Dominator (or similar) Style: Montana Finish: Smooth	Colour: Titania
Garage Door Reveal	Timber (painted)	Resene Titania
Garage Door Head Flashing	Powdercoated or painted same colour as reveal	Titania (powdercoated) OR Resene Titania (painted)
Aluminium Joinery (with clear glass which has a slight tint)	Powdercoated with Low E Glass	Titania Matt
Cat Door	No	
Front Door	Aluminium Vertical T&G (powdercoated)	Mannex colour: Titania
Front Door Handle	Kanso Lever Handle	Colour matched to front door

***Kanso hardware to all aluminium joinery – colour matched to joinery

ALL SAMPLES GIVEN OUT AT COLOUR CONSULTATION MEETINGS ARE INDICATIVE ONLY AS SOME FINISHES MAY CHANGE WITHOUT NOTICE
ALL PRODUCTS ARE SUBJECT TO AVAILABILITY AT TIME OF ORDERING

Wendy Elers PDINZ (Professional Member Designers Institute of NZ)

Office: 1 Countryridge Close, Bella Vista Rise, Paraparaumu 5032
M: 027 482 0886 | T: 04 298 8000
Email: info@stagethreedesign.co.nz
Website: www.stagethreedesign.co.nz

interior design | colour consultation | project planning | project management



EXTERIOR COLOUR SCHEME CONCEPT F
Lots 1, 13
OKATO SCHOOL DEVELOPMENT, CARTHEW STREET
TARANAKI
16.06.2025

COLORSTEEL SANDSCAPE

ROOF, FASCIA/BARGE BOARDS &
SPOUTING

SANDSCAPE
GARAGE DOOR

RESENE HALF BLACK WHITE
AXON CLADDING

SANDSCAPE
DOWNPIPES

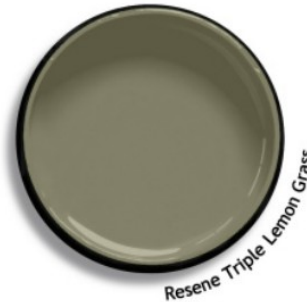

RESENE TRIPLE LEMON GRASS
LINEA CLADDING

CANVAS CLOTH
WINDOWS, JOINERY & FRONT DOOR



REPRESENTATION OF COLOURS ONLY - INDICATIVE ONLY
DETAILED SUPPORTING PAPERWORK ATTACHED

Wendy Elers PDINZ (Professional Member Designers Institute NZ)

Office: 1 Countryridge Close, Bella Vista Rise, Paraparaumu 5032

Mobile: 027 482 0886

Email: wendy@stagethreedesign.co.nz

Website: www.stagethreedesign.co.nz

Instagram: @stagethreedesign

interior design | colour consultation | project planning | project management

CLIENT: Okato School Development

SITE ADDRESS: Okato School, Carthew Street, Taranaki Status: **DRAFT – NOT FOR RELEASE**

DATE: **16.06.2025**

EXTERIOR – CONCEPT F (Lots 1, 13) (clients advised us - no colour restrictions apply on this site)		
	Product	Colour/Finish
Roof	Colorsteel	Sandscape
Soffit Flashing & Beading	Aluminium & timber (where applicable)	Painted (same colour as <u>cladding</u>)
Fascia/Barge Boards	Colorsteel	Sandscape
Spouting	Colorsteel	Sandscape
Downpipes	Colorsteel	Sandscape
Soffits	Painted	Resene Half Black White
Cladding 1	JH Linea weatherboard – horizontal (painted)	Resene Triple Lemon Grass Base: Light LRV: 29%
Cladding 2	JH Axon 133 or 400 – vertical (painted)	Resene: Half Black White Base: White LRV: 86%
Base of House	Painted (<i>only if a requirement from Council</i>)	Resene Atmosphere
Balustrading	Nil	
Garage Door (<i>not insulated</i>)	Brand: Dominator (or similar) Style: Milano Finish: Smooth	Colour: Sandscape
Garage Door Reveal	Timber (painted)	Resene Half Black White
Garage Door Head Flashing	Powdercoated or painted same colour as reveal	Appliance White (powdercoated) OR Resene Half Black White (painted)
Aluminium Joinery (<i>with clear glass which has a slight tint</i>)	Powdercoated with Low E Glass	Canvas Cloth
Cat Door	No	
Front Door	Aluminium Vertical T&G (powdercoated)	Mannex colour: Canvas Cloth
Front Door Handle	Kanso Lever Handle	Colour matched to front door

***Kanso hardware to all aluminium joinery – colour matched to joinery

ALL SAMPLES GIVEN OUT AT COLOUR CONSULTATION MEETINGS ARE INDICATIVE ONLY AS SOME FINISHES MAY CHANGE WITHOUT NOTICE
ALL PRODUCTS ARE SUBJECT TO AVAILABILITY AT TIME OF ORDERING

Wendy Elers PDINZ (Professional Member Designers Institute of NZ)

Office: 1 Countryridge Close, Bella Vista Rise, Paraparaumu 5032
M: 027 482 0886 | T: 04 298 8000
Email: info@stagethreedesign.co.nz
Website: www.stagethreedesign.co.nz

interior design | colour consultation | project planning | project management

